



Weyerhaeuser prepared this drawing for the specification of Trus Joist products based on project information provided to us. This service is solely intended for product application assurance, and is not intended to document the need for a design professional as determined by the building codes. The designer of record and/or builder/framer is responsible to assure these drawings are compatible with the over all project.

Copyright 2019 Weyerhaeuser NR Company. All rights reserved. Any unauthorized copying or reproduction will constitute an infringement of copyright.

CONTINUOUS TJI[®] JOIST OVER BEARING

FIELD CUT THROUGH THE TOP FLANGE OF TJI[®] JOIST AND FULL DEPTH OF WEB AT THE CENTERLINE OF BEARING.

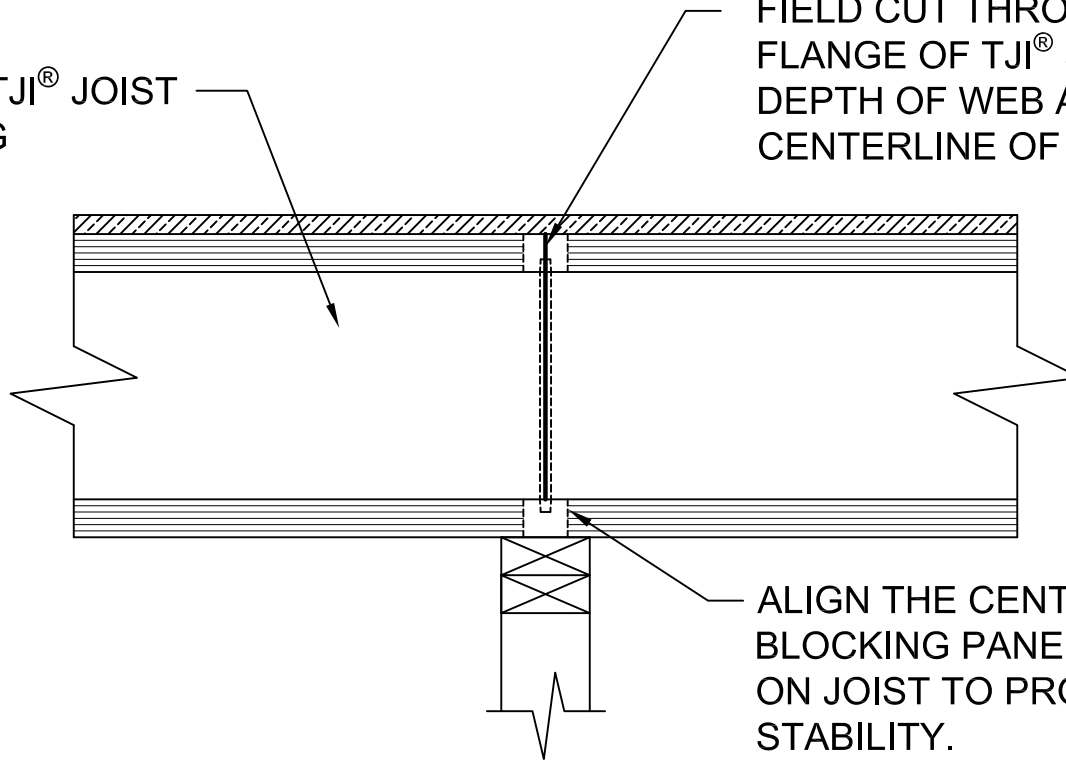

ALIGN THE CENTERLINE OF BLOCKING PANEL WITH CUT LINE ON JOIST TO PROVIDE LATERAL STABILITY.

NOTE: FIELD CUT JOISTS MUST BE DESIGNED AS SIMPLE SPAN MEMBERS TO ADEQUATELY SUPPORT APPLIED LOADS. FOR COMPLETE PRODUCT INSTALLATION INFORMATION AND TJI[®] JOIST SPAN CHARTS, REFER TO TJ-4000 TJI[®] JOIST SPECIFIER'S GUIDE.

Trus Joist Product Technical Support

Phone: (888) 453-8358

Email: TechSupport@wy.com

UPLIFT RELIEF CUT

EXPIRATION DATE:
JANUARY 2027

PROJECT #:

SERVICE #:

SHEET:

NW-D219