

**Trus Joist Product Technical Support**  
 Phone: (888) 453-8358  
 Email: techsupport@weyerhaeuser.com

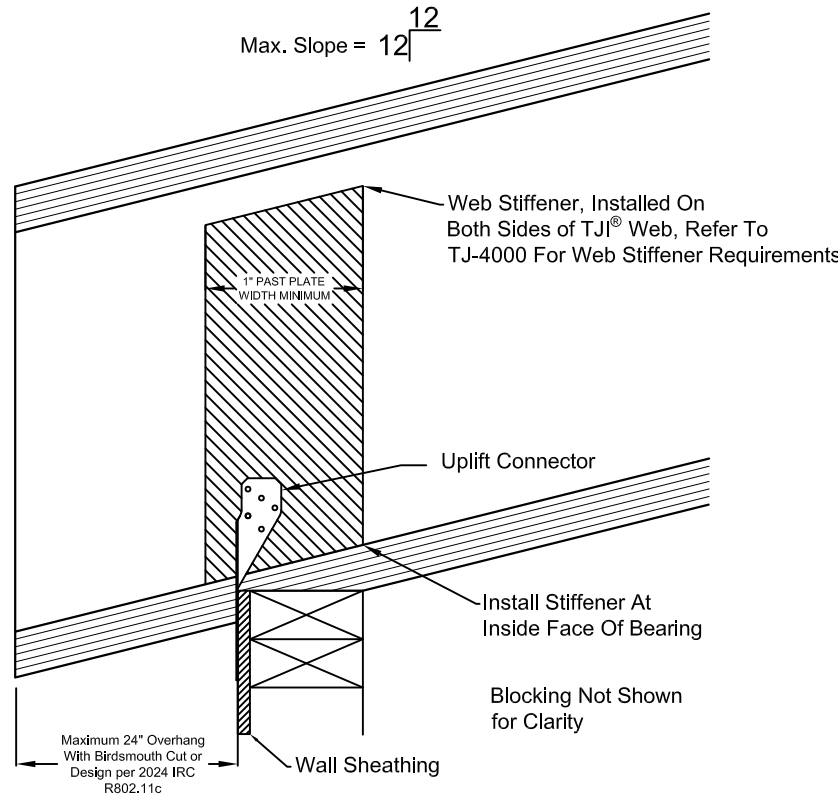

Weyerhaeuser prepared this drawing for the specification of Trus Joist products based on project information provided to us. This service is solely intended for product application assurance, and is not intended to document the need for a design professional as determined by the building codes. The designer of record and/or builder/framer is responsible to assure these drawings are compatible with the over all project.

Copyright 2023 Weyerhaeuser NR Company. All rights reserved. Any unauthorized copying or reproduction will constitute an infringement of copyright.



Connector Manufacturer <sup>(5)</sup>	Connector Type	Nail Type <sup>(2)</sup>	Allowable Uplift (160%) DF/SP Plate <sup>(4)</sup>	Allowable Uplift (160%) SPF/HF Plate <sup>(4)</sup>
USP Structural Connectors® 62 <sup>nd</sup> Ed.	RT7A <sup>(1)</sup>	8d <sup>(3)</sup>	640	565
	RT8A <sup>(1)</sup>	10d <sup>(3)</sup>	750	660
Simpson Strong-Tie® 2024 Catalog	H2.5T <sup>(1)</sup>	8d	590	565
		8d x 1-½" <sup>(3)</sup>	480	475
	H2.5A <sup>(1)</sup>	8d	700	615
		8d x 1-½" <sup>(3)</sup>	625	540
H8	10d	780	710	
	8d x 1-½" <sup>(3)</sup>	630	510	

- (1) Only install into TJI® roof joists with a 3:12 or less slope. Do not nail hurricane tie into TJI® joist flange.
- (2) 8d = 0.131" dia. x 2-1/2" long; 10d = 0.148" dia. x 3" long.
- (3) If 1-½" long nails are used to attach clip to TJI® joist, additional nails are required to attach the web stiffener to the joist to achieve published uplift value. Contact Weyerhaeuser for requirements.
- (4) Allowable loads based on nail type and quantity published by connector manufacturer.
- (5) Weyerhaeuser does not recommend the use of proprietary angle clips or screw-type fasteners that connect the joist flange directly to bearing below to resist uplift.

**GENERAL NOTES**

- REFER TO TIE MANUFACTURER FOR INSTALLATION REQUIREMENTS OF HURRICANE TIE.
- REFER TO TJ-4000 DETAIL 'W' FOR GUIDANCE ON WEB STIFFENER INSTALLATION.
- 24" OVERHANG LIMIT IS SET FOR PRESCRIPTIVE ALLOWANCE PER INTERNATIONAL RESIDENTIAL CODE (IRC), PROJECT ENGINEER OF RECORD MAY DESIGN SYSTEM FOR OVERHANGS THAT EXCEED 24".
- SEE 2024 IRC SECTION R802.11 FOR ROOF UPLIFT REQUIREMENTS.

**TJI® ROOF JOIST UPLIFT CONNECTION**

EXPIRATION DATE: JANUARY 2027

PROJECT #:

SERVICE #:

SHEET:

**NW-D217**