

UTILIZING FORTE®WEB OR JAVELIN®, RUN THE CANTILEVERED JOIST DESIGN BY APPLYING LIVE AND DEAD LOAD FROM ALL COMPONENTS (WALL, ROOF, AND DECK) TO ENSURE THE JOIST IS CAPABLE OF SUPPORTING EXTERIOR WALL AND DECK. VERIFY BOTTOM FLANGE BRACING PER FORTEWEB DESIGN REPORT.

THE ADDITION OF WEB STIFFENERS WILL HELP MINIMIZE HORIZONTAL SEPARATION OF THE RIM BOARD FROM THE TJI® JOISTS BY SIDE NAILING THE INVERTED HANGER TO THE WEB STIFFENERS, FILL ALL HOLES. ADDITIONAL SEISMIC RESTRAINT FOR THE DECK MAY BE REQUIRED. REFER TO 2021 IRC R507.9.2 FOR MORE INFORMATION.

CALCULATE THE TOTAL PLF LOAD FROM THE DECK JOISTS. TAKE THE PLF AND MULTIPLY BY THE ON CENTER SPACING OF THE TJI® JOISTS TO GET A LOAD IN POUNDS (LBS) TO BE SUPPORTED BY THE HANGER. SELECT A FACE MOUNT HANGER THAT WILL SUPPORT THIS LOAD (LBS) USING CLINCHED (0.148" x 3") NAILS. IF USING RIM WITH THICKNESS LESS THAN 1-¼" CONVERT THE HANGER CAPACITY PER HANGER MANUFACTURER RECOMMENDATIONS AND RECHECK HANGER CAPACITY.

THIS DETAIL HAS ONLY BEEN EVALUATED FOR VERTICAL LOAD. ADDITIONAL CONNECTIONS MAY BE REQUIRED FOR LATERAL FORCES. TRUS JOIST PRODUCTS ARE INTENDED FOR DRY USE ONLY. PROPER DETAILING IS CRITICAL.

NOTE: MOISTURE BARRIER SYSTEM BY OTHERS. MOISTURE BARRIER NOT SHOWN FOR CLARITY.

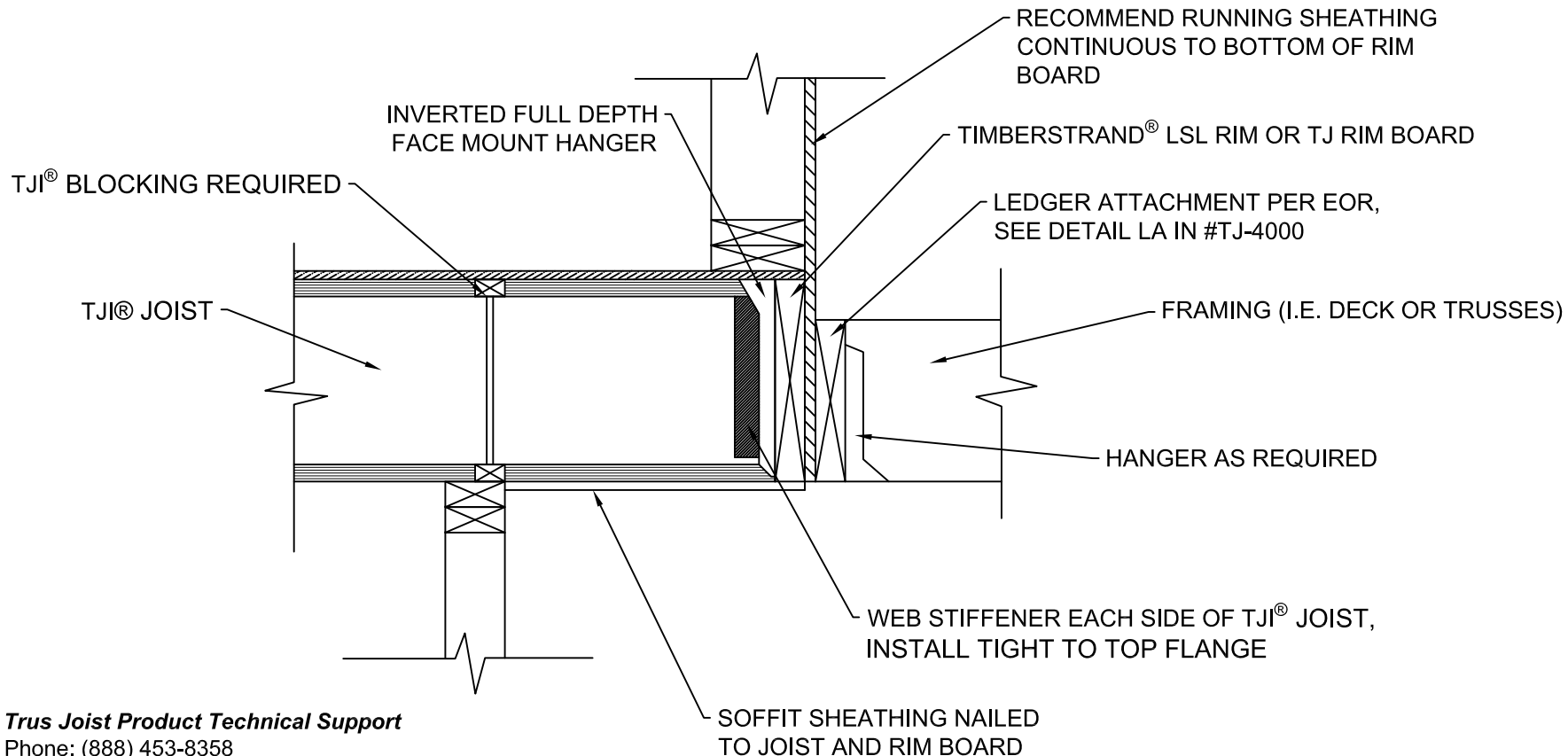

Trus Joist Product Technical Support
 Phone: (888) 453-8358
 Email: TechSupport@WY.com



Weyerhaeuser prepared this drawing for the specification of Trus Joist products based on project information provided to us. This service is solely intended for product application assurance, and is not intended to document the need for a design professional as determined by the building codes. The designer of record and/or builder/framer is responsible to assure these drawings are compliant with the over all project.

Copyright 2019 Weyerhaeuser NIR Company. All rights reserved. Any unauthorized copying or reproduction will constitute an infringement of copyright.

**CANTILEVER RIM CLOSURE
 SUPPORT FRAMING**

EXPIRATION DATE:
 JANUARY 2025

PROJECT #:

SERVICE #:

SHEET:

NW-D201